



2.0 Effective Megapixels  
**COOLPIX2500**

# Twist and Shoot



3.2 Effective Megapixels  
**COOLPIX3500**

DIGITAL CAMERAS

**COOLPIX**  
**3500**  
**2500**

**Nikon**



Two great twists on digital.

Want to capture your twist on life?

Just visit

[www.nikon-coolpix.com](http://www.nikon-coolpix.com)

for details.



**WARNING**

TO ENSURE CORRECT USAGE, READ MANUALS CAREFULLY BEFORE USING YOUR EQUIPMENT.



NIKON CORPORATION

FUJI BLDG., 2-3, MARUNOUCHI 3-CHOME, CHIYODAI-KU, TOKYO 100-8331, JAPAN

[www.nikon-image.com/eng/](http://www.nikon-image.com/eng/)

# Life.

**With a Twist.**  
Now you have two cool choices.



**COOLPIX 2500**  
2.0 Effective Megapixels



**COOLPIX 3500**  
3.2 Effective Megapixels

Ever wonder what life would be like if others could see the world through your eyes? Just get yourself a Nikon digital camera like the cool-blue COOLPIX 2500 (2.0 effective megapixels) or cool-grey COOLPIX 3500 (3.2 effective megapixels) and they can. These compact, eye-catching cameras make digital photography so enjoyable you'll want to share your twist on life with everyone. Plus, their inner-swivel lens designs let you take photos from all sorts of angles. So when you're ready for a little twist, get yourself a little COOLPIX.





 **Designed for on-the-go shooting.**

**GO-ANYWHERE DESIGN**

Lens shut away, the COOLPIX 2500's and COOLPIX 3500's smooth sleek bodies will turn heads. The combination of mirror-finish metal and cool blue or sophisticated grey makes these cameras look just as good as the pictures they take. Hidden away inside, the powerful rechargeable battery gives you up to 80 minutes of continuous use.

**IMAGE QUALITY**

With COOLPIX, great results are built in. Both models feature a 3x zoom Nikkor lens and other Nikon digital advances to deliver crisp images and brilliant colour. The COOLPIX 2500 boasts 2.0 effective megapixel resolution that is ideal for all-round use. The COOLPIX 3500's even better with an impressive 3.2 effective megapixel resolution for stunning prints at up to A4 size. It's the legendary Nikon quality squeezed into an up-to-date COOLPIX design.

**SHOOTING MODES**

Both COOLPIX cameras offer various shooting modes that make getting great shots easy. Auto mode is ideal for most photo situations, and the 12 Scene Modes help make the most out of creative situations. Just choose the right mode for the scene at hand, and the camera will handle all adjustments for you automatically.

**QUICK REVIEW**

Pressing the Quick Review button brings the last shot up onto the screen immediately without having to switch to Play mode. You can view the image either in quarter- or full-size, and if you don't like it, just delete it: if you do like it – show it around!

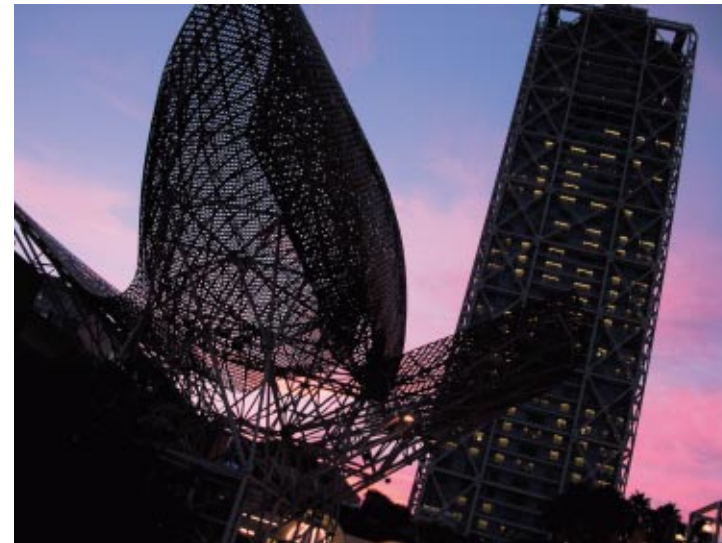

- 12 Scene Modes**
- Portrait
  - Party/Indoor
  - Night Portrait
  - Beach/Snow
  - Landscape
  - Sunset
  - Night Landscape
  - Museum
  - Fireworks Show
  - Close Up
  - Copy
  - Back Light
- Movie Mode**  
(up to 35 sec. (E3500)/15 sec. (E2500), no audio)
- Continuous Shooting Mode**





**AUTO [A]**\*

Be a digital artist: Just frame the picture, shoot and see your masterpiece. You and your friends become the art in Auto mode.

**A mode for every mood.**



**AUTO [A]**\*

You never know what you'll find when you're out and about. Be ready for anything with Auto mode.

**AUTO [A]**\*

Stop people in their tracks with great pictures, no matter what they're doing. Auto mode means life's fast moments will never pass you by.

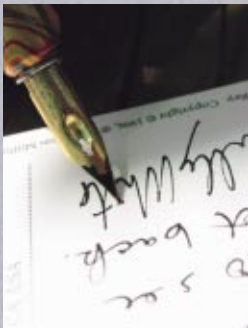

**CLOSE UP [M]**\*

The proof is in the details. Close Up mode brings out the finer points of your everyday life.

**NIGHT PORTRAIT [N]**\*

See nighttime like you've never seen it before. In Night Portrait mode, you'll uncover a whole new world, even when bright lights are your backdrop.



**PORTRAIT [P]**†

An image to last a lifetime. Use Portrait mode to capture her natural beauty against a softened background.

**PARTY/INDOOR [I]**\*

Never forget what the mood was *really* like. You and your friends will remember every nuance of the atmosphere when you use Party/Indoor mode.



**3X ZOOM**†

Never miss a beat! The versatile 3x Zoom-Nikkor lens puts the action right where you want it.

**COOLPIX can capture them all.**



\* Taken with COOLPIX 3500. † Taken with COOLPIX 2500.



 **Share your twist on life.**

**SMALL PICTURE**

E-mailing and Web posting your COOLPIX photos is an easy way to share life's moments with others. Just press the Small Picture button and the camera automatically creates a reduced-size image when in Play mode.

**ONE-TOUCH IMAGE UPLOADING**

COOLPIX makes sending images to your computer painless. Just connect your camera to the computer with the (supplied) USB cable and press the Transfer button. Selected images are then automatically transferred to the computer that you can then browse in thumbnail format with Nikon View 5 software (supplied). If you want to enlarge the image for a closer look, just click on it. Nikon View 5 even lets you adjust the colour balance or change the image size for e-mailing or Web posting. Run a slide show of selected images and print them out directly — Nikon View 5 lets you do all this from your computer.

**FOTOSHARE**

Want to use the power of the Web to share the fun of digital photography with your family and friends? Nikon FotoShare is your online album where others can share your twist on life. It's free and fun and in addition to your online albums it's the gateway to education, inspiration, news and free software from Nikon. [www.nikonfotoshare.com](http://www.nikonfotoshare.com)

\*Nikon FotoShare may not be available in some regions.



**One touch and off they go.**



**Nikon View 5 makes image browsing easy.**



**All this and more is easy.**



# COOLPIX 3500/COOLPIX 2500

Both cameras share the same nomenclature.



- 1 Shutter-release button
- 2 Mode selector/Power switch
- 3 Self-timer lamp
- 4 Lens
- 5 Built-in Speedlight
- 6 Eyelet for camera strap
- 7 Zoom buttons
- 8 Multi selector
- 9 Memory card slot/battery-chamber cover latch
- 10 Memory card slot/battery-chamber cover
- 11 Flash-ready lamp
- 12 Flash/Delete button
- 13 Scene mode/Transfer button
- 14 Menu button
- 15 Quick Review/Small Picture button
- 16 USB connector

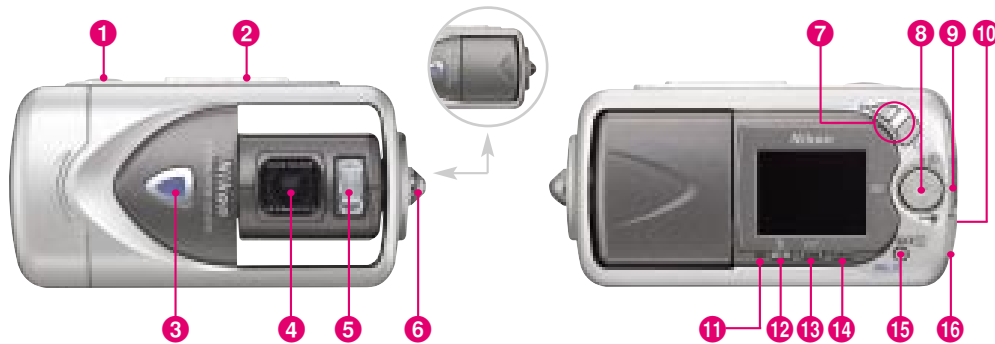

## ALL-IN-ONE PACKAGE

- Strap
- CompactFlash™ card (E3500: 16MB, E2500: 8MB)
- USB cable
- Rechargeable Li-ion Battery EN-EL2
- Battery Charger MH-60
- Nikon View 5 CD-ROM



## COOLPIX 3500 (E3500)/COOLPIX 2500 (E2500) SPECIFICATIONS

**Type:** Digital camera E3500/E2500

**Effective pixels:** 3.2 million (E3500)/2.0 million (E2500)

**CCD:** 1/2.7-in. type (3.34 million (E3500)/2.11 million (E2500) total pixels)

**Image size:**

Selectable from:

**E3500:** 2,048 (2,048 x 1,536 pixels), 1,600 (1,600 x 1,200 pixels), 1,280 (1,280 x 960 pixels), 1,024 (1,024 x 768 pixels), 640 (640 x 480 pixels)

**E2500:** 1,600 (1,600 x 1,200 pixels), 1,280 (1,280 x 960 pixels), 1,024 (1,024 x 768 pixels), 640 (640 x 480 pixels)

**Image quality (approx.):** Fine: 1/4, Normal: 1/8, Basic: 1/16

**Lens:** 3x Zoom-Nikkor; f=5.6-16.8mm (35mm format equivalent to 37-111mm); Digital zoom: up to 4.0x

**LCD monitor:** 1.5-in.; 110,000-dot low-temp. polysilicon TFT LCD with brightness adjustment

**Storage media:** CompactFlash™ (CF) card Type I

**Shooting modes:** Auto, Scene (Portrait, Party/Indoor, Night Portrait, Beach/Snow, Landscape, Sunset, Night Landscape, Museum, Fireworks Show, Close Up, Copy and Back Light), Manual (includes shooting menu for control of White Balance, Capture Mode, Best-Shot Selector, Exposure Compensation, Noise Reduction, and Image Sharpening), Movie (up to 35 sec. (E3500)/15 sec. (E2500) of QVGA frames at 15 fps.)

**Capture modes:** Single, Continuous, Multi-shot 16 (16 frames 1/16 in size)

**Number of frames w/ 16MB CF Card**

**E3500:** Fine: approx. 10, Normal: approx. 19, Basic: approx. 37

**E2500:** Fine: approx. 16, Normal: approx. 31, Basic: approx. 59

**Built-in Speedlight:**

Shooting range: approx. 0.4-3.0m/1.3-9.8 ft. (W), approx. 0.4-1.7m/1.3-9.8 ft. (T); Sensor flash system; Flash modes: Auto, Flash Cancel (off), Red-Eye Reduction, Anytime Flash (fill-flash)

**Interface:** USB 1.1

**Power requirements:** One Rechargeable Li-ion Battery EN-EL2 (supplied), AC Adaptor kit EH-60 (optional)

**Dimensions (WxHxD):** Approx. 114 x 59.5 x 31.5mm (4.5 x 2.3 x 1.2 in.)

**Weight:** Approx. 175g (6.2 oz.) (Without battery and CF card)

**Supplied accessories:** Strap, CF card (E3500: 16MB, E2500: 8MB), USB cable, Rechargeable Li-ion Battery EN-EL2, Battery Charger MH-60, Nikon View 5 CD-ROM

**Optional accessories:** Rechargeable Li-ion Battery EN-EL2, AC Adaptor Kit EH-60, Various size CF cards, LCD Hood HL-E2500, Case CS-E2500

**Nikon View 5 System Requirements**

**Macintosh**

**OS** Mac® OS 9.0-9.2 (only built-in USB ports supported), Mac® OS X (10.1.2 or later)

**Models** iMac™, iMac™ DV, Power Macintosh™ G3 (Blue & White), Power Mac™ G4 or later; iBook™, PowerBook™ G3 or later (only built-in USB ports supported)

**RAM** 64MB or more recommended

**Hard disk** 25MB required for installation, with additional amount equivalent to twice the capacity of the camera memory card plus 10MB required when Nikon View 5 is running

**Display** 800 x 600 with 16-bit colour (full colour recommended)

**Others** CD-ROM drive required for installation

**Windows**

**OS** Windows® 98SE, Windows® Me, Windows® 2000 Professional, Windows® XP Home Edition, Windows® XP Professional pre-installed model

**Models** Only models with built-in USB ports supported

**CPU** Pentium® 300MHz or higher

**RAM** 64MB or more recommended

**Hard disk** 25MB required for installation, with additional amount equivalent to twice the capacity of the camera memory card plus 10MB required when Nikon View 5 is running

**Display** 800 x 600 with 16-bit colour (full colour recommended)

**Others** CD-ROM drive required for installation

Microsoft® and Windows® are either registered trademarks or trademarks of Microsoft Corporation in the United States and/or other countries. Macintosh® and QuickTime® are either registered trademarks or trademarks of Apple Computer Inc. in the United States and/or other countries. CompactFlash™ is a trademark of SanDisk Corporation. Products and brand names are trademarks or registered trademarks of their respective companies. Images on LCDs and monitors shown in this brochure are simulated.

Specifications and equipment are subject to change without any notice or obligation on the part of the manufacturer. September 2002  
©2002 NIKON CORPORATION



"Exif Print" is the industrial term for Exif 2.2, which is a newly established standard for Digital Still Camera Image File Format.